



Version 1.0

## SAFETY INSTRUCTIONS

- Do not expose the camera to high temperatures, humidity, or dusty environments to avoid damage to internal mechanical parts.
- Avoid placing the camera in direct sunlight or hot areas (e.g., inside a car) to prevent material deformation or film damage.
- Do not attempt to disassemble or repair the camera yourself, as this may cause damage or render it inoperable.
- Keep the camera out of reach of children and pets to prevent accidental damage or misuse.
- Only use standard 35mm film (or other types compatible with this camera).
- Process exposed film promptly to prevent degradation of image quality due to prolonged storage.
- Before shooting, check that the film is correctly loaded to ensure smooth operation.
- Avoid looking directly at strong light sources (e.g., the sun) through the viewfinder to protect your eyes and maintain image quality.
- Hold the camera securely to prevent accidental drops or impacts that could damage delicate mechanical parts.
- Operate the shutter gently to avoid excessive force that could harm the mechanism.
- If the camera will not be used for an extended period, remove the film and store the camera in a dry, clean, and dark environment.
- Regularly clean the lens and viewfinder to prevent dust or mold from affecting image quality.
- If the camera becomes wet, dry it immediately and store it in a ventilated area. Seek professional repair if necessary.
- Respect others' privacy and avoid photographing people without their consent.
- Follow local laws and regulations, and refrain from using the camera in restricted or prohibited areas.

## IN THE BOX

1. 1 x Waterproof Film Camera
2. 1 x IPX8 Waterproof Case
3. 1 x Wrist Strap\*
4. 1 x 35mm colour film reel (10 exposures - preinstalled)\*
5. User guide\*
6. Warranty certificate\*

\*Not pictured

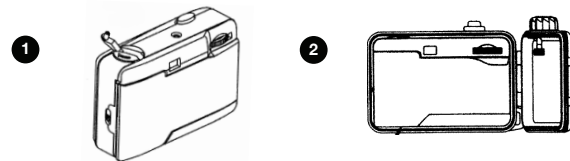

## FUNCTIONS

- a. Back of camera
- b. Side latch
- c. Winder
- d. Shutter release button
- e. View finder
- f. Locking clip

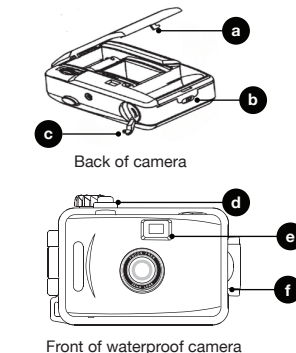

## TECH SPECS

Film:	35mm Colour film
Exposures:	10
Extras:	Wrist Strap
Focal Distance:	28mm
Aperture:	F/9
IPX8 Waterproof Case:	Up to 3m depth, 30 minutes
Shutterspeed:	1/120s

## WATERPROOF FILM CAMERA

## USER GUIDE

742816  
07/25

## INSTALLING THE CASE

Your camera comes pre-installed in the waterproof case. Follow these steps to reinstall it if needed.

1. Pull open the locking clip to unlock the waterproof case & open.
2. Swing the door open & place the camera inside the case making sure it's the right way up.
3. Close the case and latch the locking clip to lock it securely.

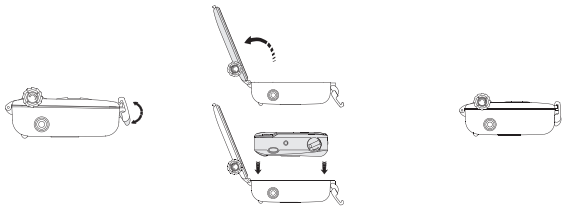

**NOTE:** Ensure the case is installed properly to avoid the risk of water damage when being submerged.

## LOADING NEW FILM

**NOTE:** The camera comes with 10 pre-installed color film exposures. Do not open the camera until you've used all the shots and rewind the film, or you risk damaging it.

To install new 35mm film follow the steps below;

### Re-winding film

Make sure the used film is fully rewound before opening the camera to avoid exposure:

1. Flip out the winder handle on top of the camera.
2. Hold down the button on the bottom of the camera.
3. Turn the winder clockwise (as marked) until the film is fully rewound.
4. Once rewound, push down the side latch of the camera to open the back of the camera and remove the film.

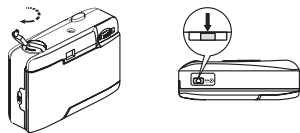

### Loading the film

1. Push down the side latch and open the camera back.
2. Flip up the handle and lift the film winder up away from the camera to pop it out.
3. Remove the existing film and insert the new 35mm film before pushing the winder back down. Make sure your film is the right way up before doing this.
4. Pull the end of the film to the right and hook the second hole onto the film take up reel ensuring the film is tight and laid flat before closing the back.

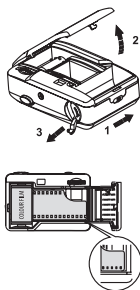

## TAKING PHOTOS

1. Close the back and turn the winder to advance the film to the first frame.
2. To take a picture, press the shutter button and turn the winder to move to the next frame.
3. As you take photos the exposure counter will display how many images you have taken. The counter only goes to 10 so if you are using more exposures you will have to keep track

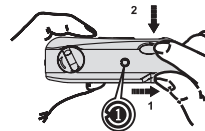

### Shooting Tips

1. Stand at least 1 metre from your subject but no more than 3 metres.
2. Use the viewfinder to line up your shot
3. Take photos in sunny or partly sunny weather.
4. Keep the sun behind you when taking pictures.

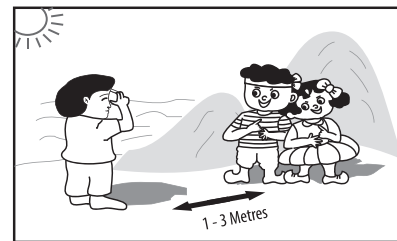

## CAMERA CONTROLS

Take Photo	Short press on either the top button of camera or blue button of waterproof case.
Advance Frames	Wind film forward using either the winder button on the camera or blue winder knob on the waterproof case.
Aim and Shoot Image	Look through the viewfinder to focus on image frame.

## AFTER SALES SUPPORT

If you experience any issues with this product or its performance is not what you had expected, please contact us at Balco Brands.

It is likely that we can resolve any problems for you via phone or email.

Phone: 0800 496 9698  
 1800 816994

Email: [UK-IRE@balcobrands.com](mailto:UK-IRE@balcobrands.com)



Packaging materials of the product are manufactured from recyclable materials in accordance with our National Environment Regulations. Do not dispose of the packaging materials together with the domestic or other wastes. Take them to the packaging material collection points designated by the local authorities.