



WIRELESS EARBUDS



BAUHN®

AFTER SALES SUPPORT

696095



(AU) 1300 663 907



CUSTOMERCARE@BALCOBRANDS.COM

MODEL: CE220827

01/2026

1

YEAR WARRANTY

CONTENTS

1 Safety Warnings	4
2 Product Overview	6
3 Power On/Off	6
4 Bluetooth Pairing	6
5 Music Controls	7
6 Call Functions	7
7 Active Noise Cancellation (ANC) & Transparency Mode	7
8 Voice Assistant	7
9 Game Mode/Low Latency Mode	7
10 Charging	7
10.1 Earbuds	7
10.2 Charging Case	7
11 Reset to Factory Settings	8
12 Specifications	8
13 Warranty	9
13.1 Warranty conditions	9

1 SAFETY WARNINGS

Earbuds can deliver sounds at loud volumes and high-pitched tones. Exposure to such sounds can result in permanent hearing loss or damage. The volume level may vary based on conditions such as the phone you are using, its reception and volume settings and the environment. Please read the safety guidelines below prior to using these earbuds.

- Prior to using this product follow these steps:
 - a) Before putting in the earbuds, turn the volume control to its lowest level.
 - b) Put the earbuds in.
 - c) Slowly adjust the volume control to a comfortable level.
- During the use of this product:
 - a) Keep the volume at the lowest level possible and avoid using the earbuds in noisy environments where you may be inclined to turn up the volume.
 - b) If increased volume is necessary, adjust the volume control slowly.
 - c) If you experience discomfort or ringing in your ears, immediately discontinue using the headphones and consult a physician.
- With continued use at high volume, your ears may become accustomed to the sound level, which may result in permanent damage to your hearing without any noticeable discomfort.

CAUTION

- » Using the earbuds while operating a motor vehicle, motorcycle, watercraft or bicycle may be dangerous, and is illegal in some jurisdictions. Check your local laws. Use caution while using your headphones when you are engaging in any activity that requires your full attention. While engaging in any such activity, removing the earbuds from your ear or turning off your earbuds will keep you from being distracted, to avoid accident or injury.
- » If you have a pacemaker or other electrical medical devices, you should consult your physician before using the product.
- Never try to dismantle the product yourself, or push objects of any kind into the product, as this may cause short circuits which could result in a fire or electric shock.
- None of the components can be replaced or repaired by users. Only authorized dealers or service centres may open the product. If any parts of your product require replacement for any reason, including normal wear and tear or breakage, contact your dealer.
- Avoid exposing your product to rain, moisture, or other liquids.
- If the product overheats, has been dropped or damaged or has been dropped in a liquid, discontinue use.
- Dispose of the product according to local standards and regulations.
- When you disconnect the power cord or any enhancement, grasp and pull the plug, not the cord. Never use a charger that is damaged.
- Attention should be drawn to the environmental aspects of battery disposal.
- The use of apparatus in moderate climates.
- This product shall not be connected to power supply source exceeding PS1.5V d.c. 15W.

CAUTION RISK OF EXPLOSION IF BATTERY IS REPLACED BY AN INCORRECT TYPE.

DISPOSE OF USED BATTERIES ACCORDING TO THE INSTRUCTIONS

- Do not dispose of a battery into fire or a hot oven, or mechanically crushing or cutting of a battery, that can result in an explosion;
- Do not leave a battery in an extremely high temperature surrounding environment that can result in an explosion or the leakage of flammable liquid or gas.
- Do not expose the battery to extremely low air pressure that may result in an explosion or the leakage of flammable liquid or gas.

2 PRODUCT OVERVIEW

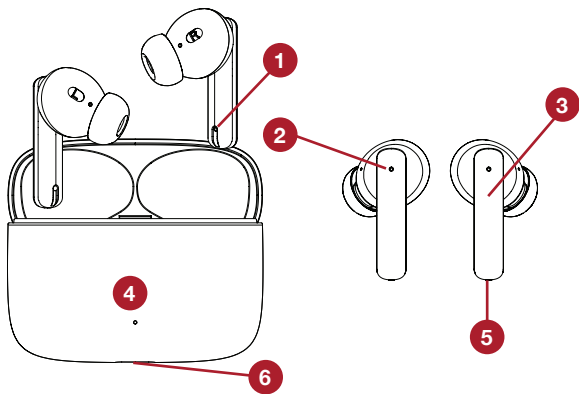

1. Talk Microphone – Captures your voice clearly during calls.
2. ANC/ENC Microphone & Indicator Light – Used for active noise cancellation and status indication.
3. Multi-function Touch Area – Controls music, calls, and settings.
4. Indicator Light – Shows battery and charging status.
5. Charging Contacts – Connect to the charging case for recharging.
6. Type-C USB Charging Port – Charge the case with included USB cable.

3 POWER ON/OFF

- **Auto Power On:** Open the charging case; earbuds turn on automatically.
- **Manual Power On:** Press the multi-function touch button for 3 seconds.
- **Auto Power Off:** Place earbuds back in the charging case and close the case; they will turn off automatically.
- **Auto Shutdown (Idle Mode):** If not connected to a device within 5 minutes the earbuds will turn off.

4 BLUETOOTH PAIRING

1. Open the charging case and the earbuds power on automatically.
2. Open your phone's Bluetooth settings and search for "CE220827".
3. Select the device and confirm pairing. You'll hear a tone when successfully connected.

5 MUSIC CONTROLS

- **Play/Pause:** Double-tap either earbud.
- **Volume Up:** Single tap the right earbud.
- **Volume Down:** Single tap the left earbud.
- **Next Track:** Triple tap the right earbud.
- **Previous Track:** Triple tap the left earbud.

6 CALL FUNCTIONS

- **Answer a Call:** Double-tap either earbud while receiving an incoming call.
- **Reject a Call:** Press and hold for 2 seconds.
- **End a Call:** Double-tap either earbud during a call.

7 ACTIVE NOISE CANCELLATION (ANC) & TRANSPARENCY MODE

- **Activate Transparency Mode:** Press and hold the right earbud button for 3 seconds. This will allow some external sound to pass through so you can hear more of your surroundings.
- **Turn On ANC:** Press and hold the right earbud button for 3 seconds again.
- **Turn Off ANC:** Press and hold the right earbud button for 3 seconds again.

8 VOICE ASSISTANT

- After successful pairing, tap four times on either earbud to activate Siri or another voice assistant.

9 GAME MODE/LOW LATENCY MODE

- **Activate/Deactivate:** Press and hold the left earbud button for 3 seconds.

10 CHARGING

10.1 EARBUDS

1. Place the earbuds into the charging case.
2. Close the lid and the earbuds begin charging automatically.
3. Charging Indicator:
 - Earbud red light = Charging
 - Light off = Fully charged

10.2 CHARGING CASE

1. Connect the Type-C USB cable to the charging port.
2. Indicator Status:
 - Red light flashing = Charging
 - Light stays on = Fully charged

11 RESET TO FACTORY SETTINGS

1. Make sure both earbuds are powered on.
2. Press and hold the multi-function area on either earbud for 8 seconds.
3. If successful, the indicator lights will flash white quickly five times, then turn off.
4. The main earbud's light will start flashing red and white, indicating it's ready to pair.

12 SPECIFICATIONS

- **Bluetooth Version:** 5.4
- **Earbuds Batteries:** 40mAh
- **Charging Case Battery:** 500mAh
- **Music Playback Time:** ~6 hours (50% Volume)
- **Bluetooth Range:** 10m
- **Earbuds Water Resistant:** IPX4 (earbuds only)
(IPX4 rating means the device is protected against splashing water from any direction. This level indicates that the device can withstand light rain or accidental splashes without being damaged.)
- **Operating ambient temperature:** 0- 45°C
- **Storage and transportation ambient temperature:** 0-45°C - Altitude not higher than 2000m (air pressure not less than 80kPa)
- **Power input:** DC 5V 500mA



- High sound pressure
- Hearing damage risk
- Do not listen at high volume levels for long periods

13 WARRANTY

Please contact the store where you purchased the item for any warranty issues.

13.1 WARRANTY CONDITIONS

Dear Customer,

The **ALDI warranty** is a full warranty offering you the following benefits:

WARRANTY PERIOD

1 year from date of purchase.

The warranty does not cover damage caused by:

- Accident or unanticipated events (e.g. lightning, water, fire).
- Improper use or transport.
- Failure to follow the safety and maintenance instructions.
- Other improper treatment or modification of the product.

After the expiration of the warranty period, you may wish to have your product repaired at your own expense. You will be notified of the repair costs in advance.

This warranty gives you specific legal rights, and you may also have other rights which vary from state to state but this warranty is not intended to exceed statutory minimum requirements beyond what is included above.

This warranty does not limit the statutory obligation of the seller arising from any implied warranties. The period of warranty can only be extended in accordance with applicable law.

Neither the service company nor ALDI will assume any liability for data or settings stored on any returned product



MADE IN CHINA

V1-1/0126