

MAXIMUS

BY
ViSAGE®

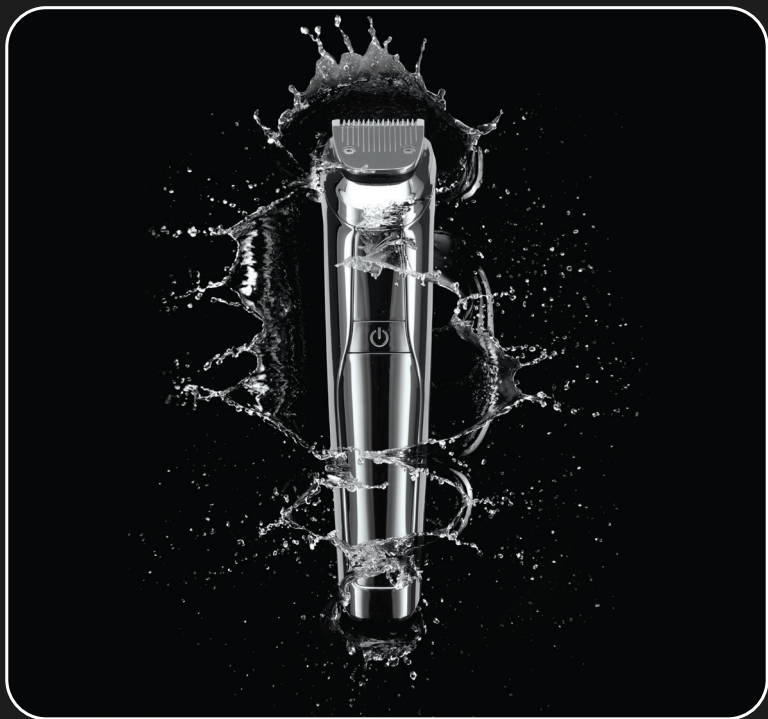

Grooming Kit

Model Number: AP210258

Product Number: 707176

USER GUIDE

Version 1.2 - Issued 18/06/21



Welcome

Congratulations on choosing to buy a Visage® product. All products brought to you by Visage® are manufactured to the highest standards of performance and safety, and, as part of our philosophy of customer service and satisfaction, are backed by our comprehensive 1 Year Warranty.

We hope you will enjoy using your purchase for many years to come.

AFTER SALES SUPPORT

 **AUS** 1300 663 907

customercare@balcobrands.com

MODEL: AP210258 PRODUCT CODE: 707176 12/2021



Contents

Welcome	2
Warranty Details	4
General Information & Safety Instructions	6
Features	7
Technical Specifications	7
Assembly & Parts List	8
Getting Started	9
Charging the battery	9
Optimising the lifetime of the rechargeable batteries	9
Lubricating the blades	9
Cutting guide	9
Attaching the guide combs	9
Operation	10
Styling/contouring your beard	10
Trimming your beard neckline	10
Trimming nose and ear hair	10
Storage	11
Cleaning & Maintenance	11
Disposal	11
FAQ	12
Repair and Refurbished Goods or Parts Notice	13
Notes	14

AFTER SALES SUPPORT

 **AUS** 1300 663 907

customercare@balcobrands.com

MODEL: AP210258 PRODUCT CODE: 707176 12/2021





ViSAGE®

GROOMING KIT

Warranty Details

REGISTER YOUR PURCHASE AT www.aldi.com.au/en/about-aldi/product-registration/ TO KEEP UP-TO-DATE WITH IMPORTANT PRODUCT INFORMATION

The product is guaranteed to be free from defects in workmanship and parts for a period of 12 months from the date of purchase. Defects that occur within this warranty period, under normal use and care, will be repaired, replaced or refunded at our discretion. The benefits conferred by this warranty are in addition to all rights and remedies in respect of the product that the consumer has under the Competition and Consumer Act 2010 and similar state and territory laws.

Our goods come with guarantees that cannot be excluded under the Australian Consumer Law. You are entitled to a replacement or refund for a major failure and for compensation for any other reasonably foreseeable loss or damage. You are also entitled to have the goods repaired or replaced if the goods fail to be of acceptable quality and the failure does not amount to a major failure.

AFTER SALES SUPPORT

 **AUS** 1300 663 907

customercare@balcobrands.com

MODEL: AP210258 PRODUCT CODE: 707176 12/2021



Warranty Note

If you experience any issues with this product, or its performance is not what you had expected, please contact us at Balco Brands

It is likely that we can resolve any problems for you via phone or email.

We can be reached on:

Phone: 1300 663 907 (Mon - Fri; 8:30am - 6:00pm EST)

Email: customercare@balcobrands.com

Web: www.balcobrands.com

General Information & Safety Instructions

Read this manual thoroughly before first use and keep it in a safe place for future reference, along with warranty card, purchase receipt and packaging. The safety precautions enclosed herein reduce the risk of fire, electric shock and injury when correctly adhered to.

Follow all instructions and take notice of all warnings to reduce risk of fire or electric shock.

- This product is intended for indoor domestic use and is not intended for commercial, trade or industrial applications.
- This appliance is not intended for use by persons (including children) with reduced physical, sensory or mental capabilities, or lack of experience and knowledge, unless they have been given supervision or instruction concerning use of the appliance by a person responsible for their safety. Children should be supervised to ensure that they do not play with the appliance. Always read all instructions before using the appliance.
- Keep the appliance and USB charging cable away from heat sources and hot surfaces.
- Always protect the USB charging cable from undue flexing and wearing – do not allow the cable to hang off edge of the counter or table.
- Do not operate with aerosol spray products or where oxygen is being administered.
- Only for use on facial hair.
- Do not use if there is any damage to the blades or tracks as it may cause injury.
- Do not insert any object into any opening in the appliance.
- Do NOT use the appliance in the shower if it is plugged in
- Do not use in dusty conditions
- Do not place or store the appliance where it can fall or be pulled into a sink or bath.
- Do not drop the appliance. Dropping or rough use of the unit may cause damage
- Do not place near strong magnets or strong electric currents
- Unless charging, always unplug this appliance from the power point immediately after use and after charging.
- Unplug the appliance before cleaning.
- If the appliance is not in use, turn off and unplug from any power source
- Do not attempt to repair, open or alter any components of the appliance. In the case of improper usage or if you have opened, altered and repaired the product yourself, all guarantees are void
- The supplier does not accept responsibility for additional or consequential damage other than covered by legal product responsibility
- Do not use the appliance for other than intended or specified purposes.
- The supplier is not responsible for the end use of this product including any improper use or when used for purposes that are not specified
- The appliance contains battery that are only replaceable by skilled person
- **WARNING:** Detach the appliance from the supply cord before cleaning it in water
- The product must only be supplied at safety extra low voltage corresponding to the marking on the appliance.
- The supply terminals are not to be short-circuited.
- **WARNING:** Use only an external supply with 5V DC 1A output.
- This appliance contains battery that is non-replaceable. When the battery is at end of life, the appliance shall be properly disposed of.
- Dispose of used batteries to local regulations properly.
- Do not expose the appliance or battery to excessive temperatures.
- Be aware of the risk of terminal of the battery operated appliance or battery being short circuited by metal objects.
- Do not expose battery to heat or fire. Avoid storage in direct sunlight.
- In the event of a battery leaking, do not allow the liquid to come in contact with skin or eyes. If contact has been made, wash the affect area with copious amounts of water and seek medical advice.
- The water resistance rating of the shaver is IPX7, which means it is suitable for cleaning under an open water tap



Suitable for cleaning under an open water tap

This product complies with AS/NZS 60335.1 and AS/NZS 60335.2.8

AFTER SALES SUPPORT



AUS 1300 663 907

customercare@balcobrands.com



Features

- Stainless steel blades
- 600mAh lithium rechargeable battery
- 90min charge time / 90min run time
- Interchangeable combs - 1/2mm & 3/6/9/12mm
- IPX7
- LED digital display
- Nose hair trimmer
- Displays battery life, charge time & safety lock

Technical Specifications

Model Specification:	AP210258
Warranty:	1 Year
Battery:	3.7V 600mAh
Battery type:	Li-ion cell
Power system:	Cordless (rechargeable)
Power:	5W
Rated input:	DC 5V 1A

AFTER SALES SUPPORT

  1300 663 907

customercare@balcobrands.com

MODEL: AP210258 PRODUCT CODE: 707176 12/2021



Assembly & Parts List

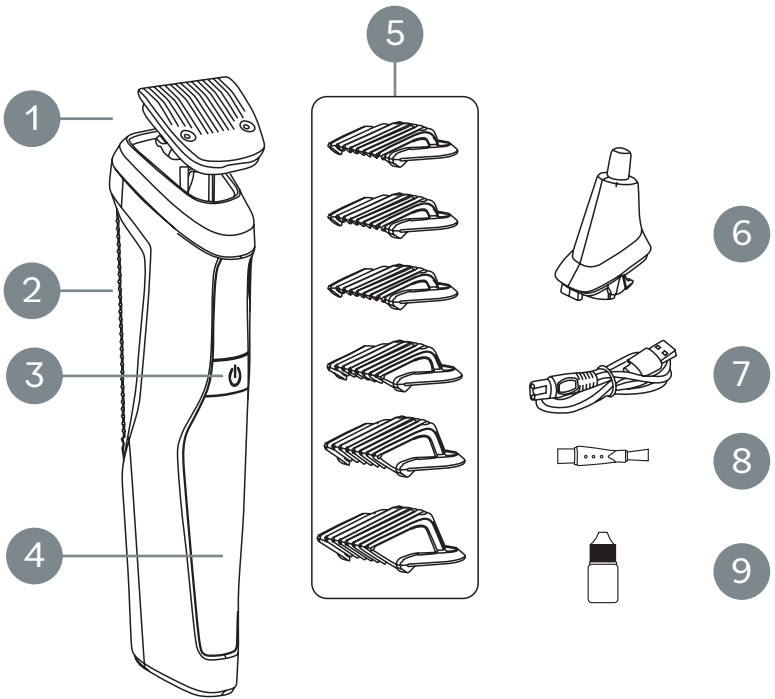

- 1. Trimmer blade
- 2. Groomer body
- 3. On/Off button
- 4. LED display
- 5. 6 x guide combs

- 6. Nose hair trimmer attachment head
- 7. USB charging cable
- 8. Cleaning brush
- 9. Oil

- 10. Scissors*
- 11. Carry case*
- 12. User guide*
- 13. Warranty card*

* Not pictured

AFTER SALES SUPPORT

 **AUS** 1300 663 907

customercare@balcobrands.com

MODEL: AP210258 PRODUCT CODE: 707176 12/2021



Getting Started

Charging the battery

- Before using your groomer for the first time, charge it fully for 90 minutes
- Plug the USB charging cord into your groomer and then plug the USB end into a USB power source. Please ensure that the groomer is OFF. The LED display will indicate the amount of charge in the groomer, once it displays 99 this means it is fully charged

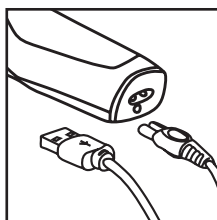

Optimising the life of the rechargeable batteries

- Discharge the rechargeable batteries completely twice a year by letting the motor run until it stops. Then fully recharge the batteries

Lubricating the blades

It is highly recommended before each use to lubricate the blades with the oil provided. This ensures optimum cutting performance.

1. Plug the USB cord into a USB power adaptor and ensure it is switched ON
2. Use the oil supplied to lubricate the blade. Unscrew the cap and cut off the tip of the oil tube with a pair of scissors
3. Switch on the groomer, then gently squeeze the oil tube, applying 2 drops onto the blades. Leave the groomer switched ON for a further few seconds to allow the oil spread thoroughly along the length of the blades. Then, switch OFF the unit and remove any excess oil using a cloth

Cutting guide

NOTE:

- Always inspect the appliance before use to ensure the groomer blades are free from hair, debris etc.
 - When you trim your beard for the first time, please be careful. Do not move the groomer too fast.
1. Place the bottom lip of the trimmer blade into the body of the groomer
 2. Push downwards until the blade clicks into place

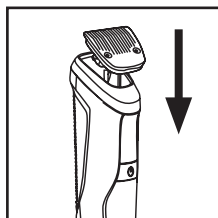

NOTE: If you press the on/off button for 3 seconds, the product locks. To unlock press and hold for 3 seconds

Attaching the guide combs

1. The groomer can be used with or without the guide comb attachments. To attach the guide combs, slide one onto the trimmer blade head until it clicks into position

NOTE: The appliance must be switched off while the guide comb is being attached or removed.

2. There are 6 guide combs. The hair can be cut to different lengths ranging from 1,2,3,6,9,12mm
3. Switch on the groomer

AFTER SALES SUPPORT



customercare@baldcobrand.com

MODEL: AP210258 PRODUCT CODE: 707176 12/2021



Operation

NOTE: Whilst this grooming kit can be used in the shower, ensure it is not plugged in or charging whilst being used in the shower

Styling/contouring your beard

You can use the groomer to contour or cut shapes in beard hair. It cuts hair very close to the skin, at a length of 1mm. Be careful when you use the precision trimmer because it removes every hair it comes into contact with.

1. The best way to trim your beard is to start with the longest hair length and bring it down gradually. Set your groomer to its longest setting and trim your beard all over
2. Go against the direction of hair growth to remove excess bulk. Repeat using shorter guide combs until you're happy with the length
3. Make careful and controlled movements
4. Just like the hair on the top of your head, your beard needs moisture to stay healthy. So finish the whole process off with a good beard oil to moisturize and help keep your facial hair looking its best. Then run a beard comb through it to distribute the oil, as well as to style your beard back into place, post-trim. This will also help to reveal any uneven hair which you can trim away using scissors

Trimming your beard neckline

1. Start in the centre of your neck at your Adam's apple and trim every hair below the line you've identified as your beard neckline
2. Trim from the centre, taking your groomer up towards one ear, being mindful of your jawline as you go

Trimming nose and ear hair

Nose hair

1. Place the bottom lip of the nose/ear trimmer into the body of the groomer
2. Push upwards until the nose/ear trimmer clicks into place
3. Make sure your nostrils are clean
4. Switch on the appliance and insert the tip of the trimmer into one of your nostrils

NOTE: Do not insert the tip more than 2.5mm into your nostril.

5. Slowly move the tip in and out while turning it round at the same time to remove unwanted hair

NOTE: To reduce the tickling effect, make sure that you press the side of the tip firmly against the skin.

Ear hair

1. Place the bottom lip of the nose/ear trimmer into the body of the groomer
2. Push upwards until the nose/ear trimmer clicks into place
3. Clean the outer ear channel. Make sure it is free from wax
4. Switch on the trimmer and move the tip softly round the ear to remove hairs that stick out beyond the rim of the ear

NOTE: Do not insert the tip more than 2.5mm into your ear canal.

AFTER SALES SUPPORT

 (AUS) 1300 663 907

customercare@baldcobrand.com

MODEL: AP210258 PRODUCT CODE: 707176 12/2021



Storage

When not in use, unplug the appliance and store out of reach of children in a safe, dry location. Never wrap the cord around the appliance as this will cause the cord to wear prematurely and break. Handle the cord carefully, and avoid jerking, twisting or straining especially at plug connection

Cleaning & Maintenance

Before cleaning the groomer ensure it is turned off and unplugged from the power outlet.

LIGHTLY RINSE THE APPLIANCE HEAD UNDER RUNNING WATER. ALLOW TO AIR DRY AS USING A TOWEL MAY DAMAGE THE BLADES. NEVER USE COMPRESSED AIR, SCOURING PADS, ABRASIVE CLEANING AGENTS OR AGGRESSIVE LIQUIDS SUCH AS ALCOHOL, PETROL OR ACETONE TO CLEAN THE APPLIANCE. DO NOT USE ANY SHARP OBJECTS TO CLEAN THE APPLIANCE.

To maintain optimum performance, the appliance should be cleaned after each use:

- Remove the attachment comb - the attachment combs can be rinsed under water. Please ensure comb's surface are dried thoroughly before storage or further use
- Using the cleaning brush, brush and blow away any remaining hair from the blades and from the neck
- Do not disassemble the blades of the groomer
- Clean the appliance after every use

Disposal

At the end of its working life, do not throw this product out with your household rubbish. Electrical and electronic products contain substances that can have a detrimental effect on the environment and human health if disposed of inappropriately. Observe any local regulations regarding the disposal of electrical consumer goods and dispose of it appropriately for recycling. Contact your local authorities for advice on recycling facilities in your area.

Please keep the original packaging carton and materials in a safe place. It will help to prevent any damage if the product needs to be transported in the future. In the event it is to be disposed of, please recycle all packaging material where possible.

If you require another copy of this instruction manual, please contact customercare@baldobrand.com to obtain an electronic copy.

AFTER SALES SUPPORT

 (AUS) 1300 663 907

customercare@baldobrand.com

MODEL: AP210258 PRODUCT CODE: 707176 12/2021



FAQ

Problem	Solution
Why isn't my groomer turning on?	<ul style="list-style-type: none">• Ensure the battery is fully charged, see Charging the battery on page 9 for reference
What does the LED display show?	<ul style="list-style-type: none">• Displays battery life, charge time & safety lock
How long does it take to charge?	<ul style="list-style-type: none">• It takes approximately 90 minutes to fully charge. LED display will indicate '99' when fully charged

AFTER SALES SUPPORT

 **AUS** 1300 663 907

customercare@balcobrands.com

MODEL: AP210258 PRODUCT CODE: 707176 12/2021





ViSAGE®

GROOMING KIT

Repair and Refurbished Goods or Parts Notice

Unfortunately, from time to time, faulty products are manufactured which need to be returned to the Supplier for repair.

Please be aware that if your product is capable of retaining user-generated data (such as files stored on a computer hard drive, telephone numbers stored on a mobile telephone, songs stored on a portable media player, games saved on a games console or files stored on a USB memory stick) during the process of repair, some or all of your stored data may be lost.

We recommend you save this data elsewhere prior to sending the product for repair.

You should also be aware that rather than repairing goods, we may replace them with refurbished goods of the same type or use refurbished parts in the repair process.

Please be assured though, refurbished parts or replacements are only used where they meet ALDI's stringent quality specifications.

If at any time you feel your repair is being handled unsatisfactorily, you may escalate your complaint. Please telephone us on 1300 663 907 or write to us at:

Balco Brands Pty Ltd

PO Box 537 Bayswater Business Centre, Victoria, Australia

1300 663 907 - Hours: Mon-Fri 8:30am - 6:00pm AEST

customercare@balcobrands.com

AFTER SALES SUPPORT

 (AUS) 1300 663 907

customercare@balcobrands.com

MODEL: AP210258 PRODUCT CODE: 707176 12/2021



MAXIMUS

BY

ViSAGE[®]