

# VIBRATING SCULPTING ROLLER

## User Guide

Model: BE220407  
Version 1.1



### Safety Instructions

- This product is intended for domestic use only. It is not intended for commercial, trade or industrial use.
- **WARNING:** Keep the appliance dry.
- Do not use while bathing or in the shower.
- Do not place or drop into water or other liquid.
- The battery should not be recharged.
- Please remove the exhausted batteries from the appliance and safely dispose.
- If the appliance is to be stored unused for a long period, the battery should be removed.
- Never short-circuit the supply terminals of batteries.
- The supplier is not responsible for the end use of this product including any improper use or when used for purposes that are not specified.
- This appliance is not intended for use by persons (including children) with reduced physical, sensory or mental capabilities, or lack of experience and knowledge, unless they have been given supervision or instruction concerning use of the appliance by a person responsible for their safety.
- Children should be supervised to ensure that they do not play with the appliance.
- Cleaning and user maintenance shall not be made by children without supervision.

### Parts List

1. 1 x Contouring roller head
2. 1 x Facial roller handle
3. 1 x T-bar head
4. 1 x Velvet storage bag\*
5. 1 x Activ Energy AA battery\*
6. 1 x User guide\*

*\*Not shown*



### Getting Started

Remove any packaging material and labels before using your LACURA Beauty® Vibrating Sculpting Roller for the first time.

Do not use the appliance if any part has been damaged. In case of damage, contact our After Sales Support line for advice on a replacement or return. Damage caused by misuse is not covered under warranty.

#### Adding Batteries

The battery compartment is in the main body of the Vibrating Sculpting Roller. To install/replace the battery follow the below steps.

1. Remove the bottom base by twisting counter clockwise until it unscrews completely.
2. Insert 1 x AA battery. Either negative or positive end going in first are both workable.
3. Twist the battery cover clockwise until it is secure.

#### Turning On/Off

1. To turn on, rotate base counter clockwise until vibration starts.
2. To turn off, rotate base clockwise until vibration stops.

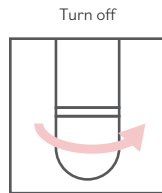
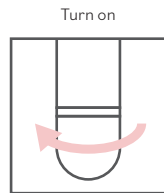
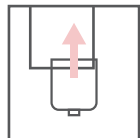
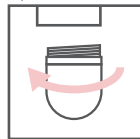

### Interchangeable Heads

The Vibrating Sculpting Roller comes with two interchangeable heads - contour roller & T-bar. To change the head, follow the below steps.

1. Hold the body of the facial roller with a firm grip.
2. Unscrew the head counterclockwise until the head is fully removed.
3. Replace with desired head and screw back on in a clockwise motion until it is fully secure.

The contouring roller is designed to help stimulate circulation, promote collagen production, and help contour the face.

The T-bar helps target specific areas to help reduce puffiness and reduce the appearance of fine lines and wrinkles.

*Both interchangeable heads can be placed in the fridge prior to use. Placing the heads in the fridge before use will maximize the cooling effect. Do not place the main body which contains the battery in the fridge as low temperatures drains the battery very quickly.*

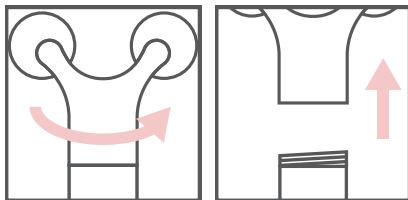

Unscrew

Remove

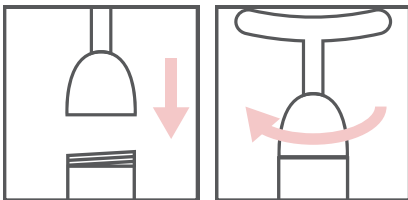

Attach

Tighten

### Operation

#### Using the Vibrating Sculpting Roller

A 10-minute Vibrating Roller session is like an intense workout for your entire face. For optimal results use morning and night for up to 10 minutes. Your skin will begin to feel more toned, lifted, sculpted, and refreshed.

Apply 1-2 drops of cleanser, serum or moisturiser to each area of the face and spread evenly.

Follow the massage diagram. Use upward and outward movements. Repeat in one direction for 8-12 strokes in each area.



#### Tips for use

- Due to the high power and sonic vibrations we recommend replacing the battery every 2 weeks or so (based on daily usage, which we advise for best results).
- If you feel your Vibrating Sculpting Roller vibration frequency is getting weaker, then it is time to replace the battery.
- While using the Sculpting Roller each day, your skin might become pink/red, this is a result of the increased circulation and blood flow.
- For an extra relaxing routine, you can put your Sculpting Roller heads in the fridge for 5-10 minutes, making the heads cold on contact with the skin. This is perfect in the mornings to reduce the appearance of puffy eyes and cheeks.
- Do not put the main body of the Sculpting Roller in the fridge as it contains a battery. Only refrigerate the interchangeable heads.